

本圖面若與目錄之規格尺寸不符，以本圖面規格尺寸為主。
Below is our main specification if different from catalog.

RoHS compliant

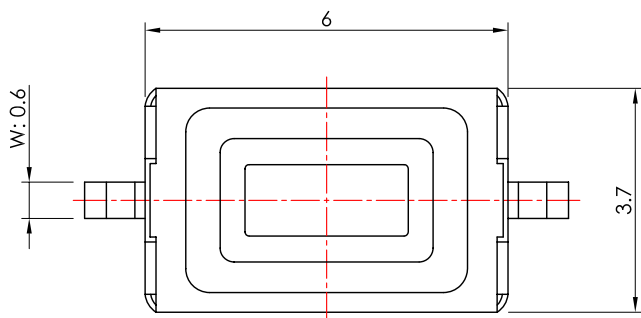

CIRCUIT DIAGRAM

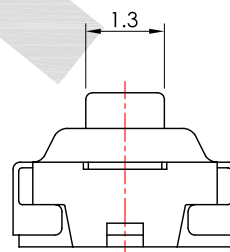
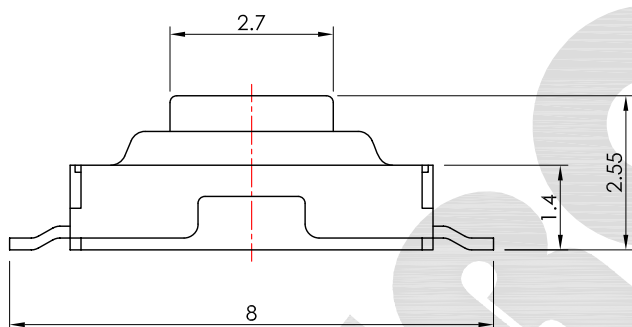

P.C.B REFLOW PATTERN

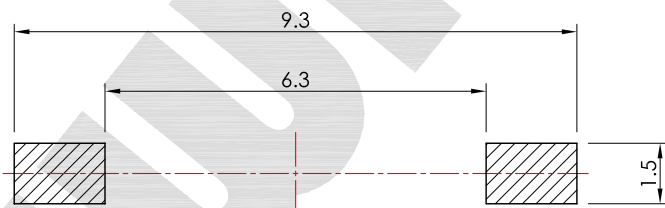

RoHS compliant

IT-1181X-XXXG-G

MODEL NO.	W
□	0.6
A	0.8

OPERATING FORCE
180、250



SPECIFICATION

Rating: 50mA 12V DC Max.

Circuit: SPST.

Function: OFF-(ON).

Travel: 0.25±0.1mm.

Contact resistance: 100mΩ Max.(initial)

Operating force: 180±50g.

Life: 50,000 Cycles Min.

Minimum load: 10mA 3.3V DC.(reference only)

Soldering temperature: 250° C Max. for 3 Sec.

Soldering time: 1 time only.

Note: Unwashable, don't be immersed by epoxy and organic solvent.



CV3.2			
CV3.1		操作力變更	2010.11.22
CV3.0	無	新繪製	2009.12.29
版本 VER.	符號 SYMBOL	修改內容 ALTERATION	更新日期 DATE

產品 PRODUCT		Tact Switch		型號 MODEL NO.	IT-1181-180G-G
比例 SCALE	8 : 1	單位 UNIT	mm	<p>一綺電子企業股份有限公司 總公司：110 台北市信義路四段415號13樓之3 13F-3 NO. 415, SEC. 4, HSIN YI ROAD, TAIPEI, TAIWAN TEL : 886-2-27290229 (Rep.) FAX : 886-2-27582086 URL : http://www.switronic.com.tw E-MAIL : switches@ms36.hinet.net</p>	
公差 TOLERANCE	±0.3mm				
製圖 DRAWN BY	核圖 CHECKED BY	主管 APPROVED BY			
Johnny Chang	Nail Chen	Margaret Lee			