

WW158B-M01E (5A/250V)

WW158B-M04E (5A/250V)

WW158B-M06E (5A/250V)

Specification:

Material: Nylon 66 UL94V-2

Current rating:

5A AC, DC Max

Voltage Rating:

300V AC, DC Max

Contact resistance:

15mΩ Max

Insulation resistance:

1000MΩ Min

Withstanding voltage :

1500V AC/Minute

Temperature range:

-25°C to +85°C

Applicable panel thickness:

2 mm max

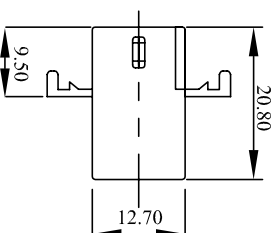
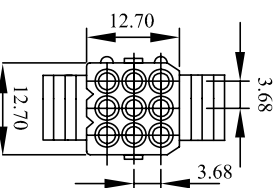
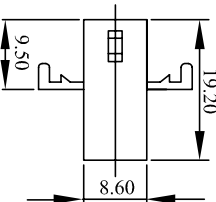
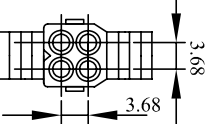
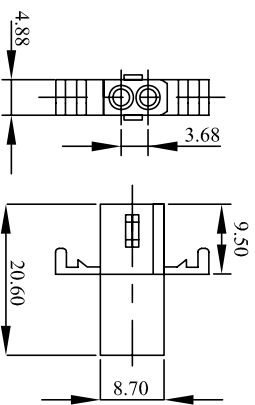

WW158B-M02E (5A/250V)

WW158B-M04-1E (5A/250V)

WW158B-M09E (5A/250V)

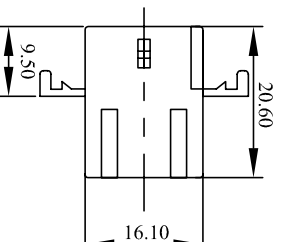
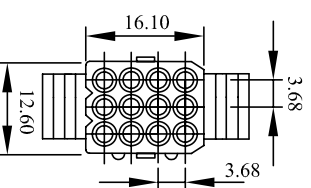
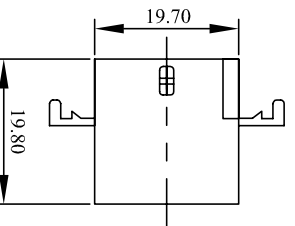
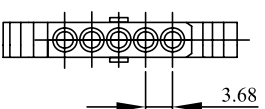
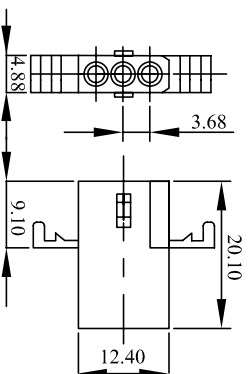

WW158B-M03E (5A/250V)

WW158B-M05E (5A/250V)

WW158B-M12E (5A/250V)

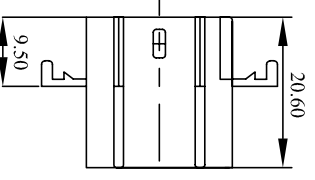
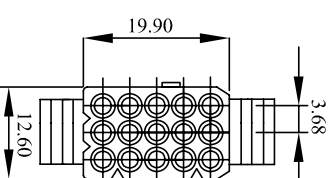

WW158B-M15E (5A/250V)

REV DESCRIPTION/DATE

DRAWN BY: STORMLI

CUSTOMER:

THIRD ANGLE PROJECTION



UNITS: MM

△ CHECKED BY: SIMMON

APPROVED BY: TONY

PART NO.:

WW158B-M(E) Series

GENERAL DIMENSION TOLERANCE

X.X ±0.25 XXX ±0.1 XXXX ±0.08

△

SGS REPORT NO.: KA/2004-80788/A-2

TITLE:

Housing

2

3

4

5

6

7

8

9

10

11

12

13

14